



## Site Layout – Phase 1

An agreement has been made by Lion Estates and the Landowner at 1E Springdale Mews, for the license to allow the contractor to use the freeholders land to place the site office and welfare units

Welfare units proposed :

1x toilet

1x wash basin

Hot water

Somewhere clean and dry to eat/take breaks/change etc

1 x cabin

<https://www.mk-containers-ukwide.co.uk/MobileProductList.php?CatType=MainCat&CatID=602>

**THERE IS NO ON-SITE PARKING IN LINE WITH CONSTRUCTION TRAFFIC MANAGEMENT PLAN**

**ALL MATERIALS WILL BE DELIVERED AND STORED WITHIN THE BOUNDARIES OF THE SITE**

**Project:** Springdale Mews, Stoke Newington, London, N16 9NR

**Title:** Site Layout – Excavation Phase (1 of 2)

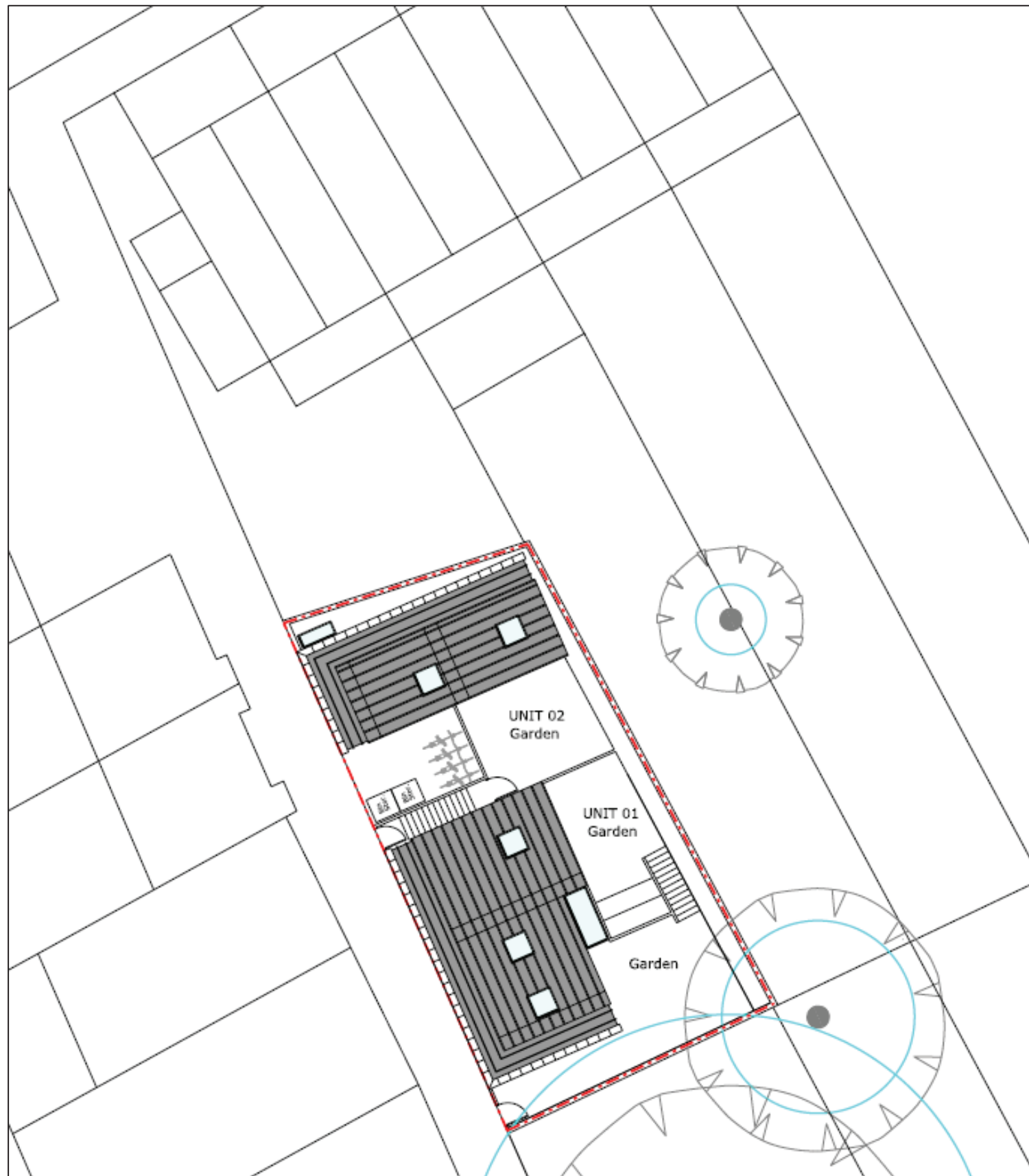

## Site Layout - Phase 2

An agreement has been made by Lion Estates and the Landowner at 1E Springdale Mews , for the license to allow the contractor to use the freeholders land to place the site office and welfare units

Welfare units proposed :

1x toilet

1x wash basin

Hot water

Somewhere clean and dry to eat/take breaks/change etc

1 x cabin

<https://www.mk-containers-ukwide.co.uk/MobileProductList.php?CatType=MainCat&CatID=602>

**THERE IS NO ON-SITE PARKING IN LINE WITH CONSTRUCTION TRAFFIC MANAGEMENT PLAN**

**ALL MATERIALS WILL BE DELIVERED AND STORED WITHIN THE BOUNDARIES OF THE SITE**

**Project:** Springdale Mews, Stoke Newington, London, N16 9NR

**Title:** Site Layout – Construction Phase (2 of 2)